



BOAT LANDING LIGHT

MBL 160-BL



The MBL 160-BL is a landing light fitted with LED diodes of high intensity, especially designed for offshore wind farm lighting purposes, with a high-efficiency luminous system and a low consumption.

Ideal for permanent beaconing of off-shore wind farms or platforms. This lantern is ready to integrate a monitoring and a synchronising system based on bus topology.

Its luminous source consists of an innovating lens system especially designed to take the maximum profit of LED diodes, providing the required safety illumination on landing situations. Manufactured with high-quality and resistant materials, the MBL 160-BL provides a long service life under harsh marine conditions.

Designed according to IALA Recommendations.

FEATURES

- ✓ Remote monitoring signals available by RS-232 serial port or digital outputs.
- ✓ High-efficiency luminous system.
- ✓ Average operation lifetime over 10 years.
- ✓ IP 68 watertightness degree (immersion resistant).
- ✓ Linear adjustment of luminous intensity.
- ✓ Internal photocell adjustable in lux.
- ✓ Double RS-232 serial port for setting adjustments by PC and remote monitoring system.
- ✓ Programming, configuration and operating status via PC, Modbus, IR programmer or Bluetooth.
- ✓ Ready to integrate remote monitoring via GSM, VHF or satellite, synchronization via GPS or AIS AtoN module.
- ✓ Short-circuit, reverse-polarity and transient over-voltage protections.



BOAT LANDING LIGHT

MBL 160-BL



Specifications subject to change without previous notice.

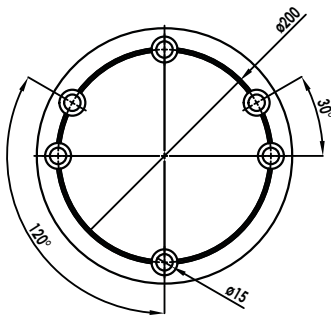
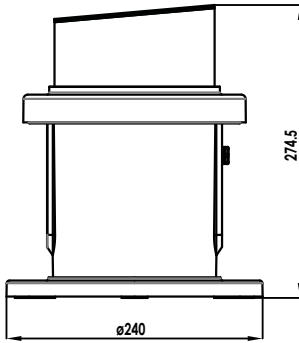

Optical System

Light source:	Ultra-bright LED diode, with high-precision acrylic lens.
Colours available:	White, green, red and amber.
LED average life:	More than 100,000 hours.
Power supply:	From 9 to 36V (From 190 to 270V a.c. optional).
Lantern consumption:	From 3 to 24W (adjustable).

Electronic control

Day/night threshold:	Adjustable between 10 and 400 lux.
Luminous intensity adjustment:	Linear, between 10 and 100% by Modbus.

Materials and environment

Base:	Glass-fibre reinforced polyamide PA66-GF30.
Lens cover:	Acrylic, UV stabilised.
Vibration resistance:	MIL-STD-202G, Method 204D (5G).
Shock resistance:	MIL-STD-202G, Method 213B.
Watertightness degree:	IP 68.
Fixings:	4 bolts in a 200mm diameter.
Humidity resistance:	100%. Pressure-compensation valve to avoid condensation.
Temperature range:	From -30° to 70°C.

Options

Infrared (IR) programmer.
PC programming kit.
RS-485 Modbus serial port.
Other specifications available under request.



MEDITERRÁNEO SEÑALES MARÍTIMAS, S.L.L.
 mesemar@mesemar.com • www.mesemar.com

