



NBM Nautical Buoys are especially designed for beach buoyage or channels where a temporary marking is required.

They are manufactured with rotomoulded virgin polyethylene in one piece. Polyethylene includes the necessary pigment that provides the colour (chromaticity according to IALA Recommendations.). UV filters guarantee a stable colour protection during its whole service life. Reinforcements are included from the floating line to the mooring eye.

They can be filled with closed-cell expanded polyurethane foam under customer request.

**FEATURES**

**COLOUR TABLE**

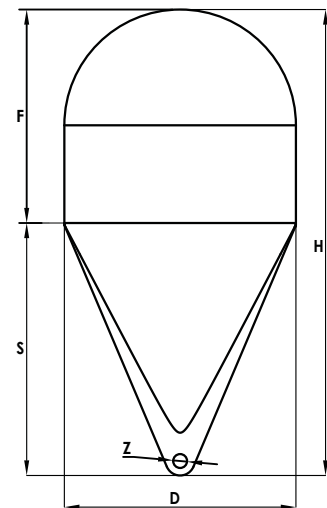

| Spherical buoys | H (mm) | F (mm) | S (mm) | DØ (mm) | ZØ (mm) | Buoyancy (L) |
|-----------------|--------|--------|--------|---------|---------|--------------|
| NBM 04-ESF      | 660    | 315    | 345    | 400     | 38      | 45           |
| NBM 06-ESF      | 1,100  | 494    | 606    | 600     | 48      | 227.5        |
| NBM 08-ESF      | 1,610  | 745    | 865    | 800     | 48      | 410          |

# NAUTICAL BUOYS

# NBM



Specifications subject to change without previous notice.

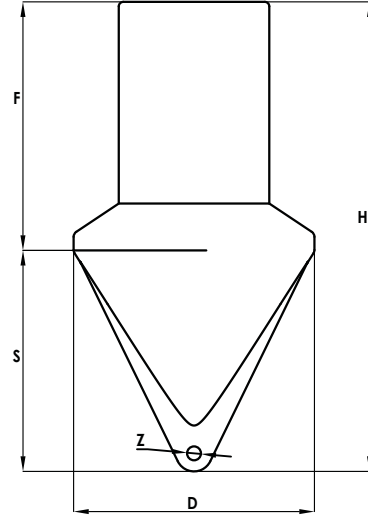

| Cylindrical Buoys | H (mm) | F (mm) | S (mm) | DØ (mm) | LØ (mm) | ZØ (mm) | Buoyancy (L) |
|-------------------|--------|--------|--------|---------|---------|---------|--------------|
| NBM 04-CIL        | 740    | 377    | 363    | 400     | 250     | 38      | 35           |
| NBM 08-CIL        | 1,610  | 960    | 650    | 800     | 500     | 48      | 290          |

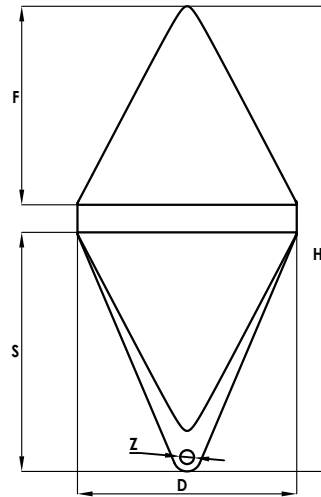

| Conical buoys | H (mm) | F (mm) | S (mm) | DØ (mm) | ZØ (mm) | Buoyancy (L) |
|---------------|--------|--------|--------|---------|---------|--------------|
| NBM 04-CON    | 640    | 277    | 363    | 400     | 38      | 25           |
| NBM 08-CON    | 1,600  | 800    | 800    | 800     | 48      | 200          |



**MEDITERRÁNEO SEÑALES MARÍTIMAS, S.L.L.**  
 mesemar@mesemar.com • www.mesemar.com

