



The MLC 02 automatic 2-position lampchangers are suitable for rotating beacons and major lighthouses. Especially engineered for all type of lamps and sockets, including big-size lamps.

Designed to work under harsh marine conditions with high-corrosion level, ensuring a correct and nonstop operation of marine aids to navigation.

With capacity for 2 lamps, either halogen or metal halide, it fits perfectly in both rotating and flashing lighthouses, with 3,000W maximum lamp power.

FEATURES

- ✓ Adaptable to rotating and horizon lighthouses, with 3,000W lamp power.
- ✓ Accurate lamp focusing, reversible motor drive.
- ✓ Contact-free and brushless operation.
- ✓ Wide range of lamps sockets and lampholders (Gx9.5, G12, G21, G22, E40, etc.).
- ✓ Thermal protection of wires from damages due to sun light.
- ✓ Anodized marine aluminium turret and arms.
- ✓ Stainless-steel base.
- ✓ Stainless-steel hardware.
- ✓ Two versions available, depending on the power required.
- ✓ High resistance to marine corrosion.
- ✓ Lamp-status detecting photocell.



MLC 02



Specifications subject to change without previous notice.

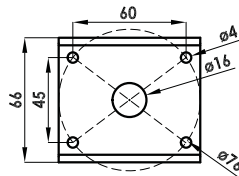
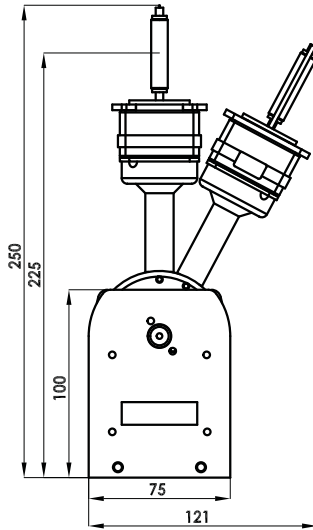

Type A

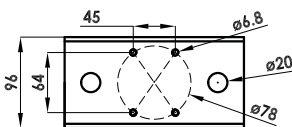
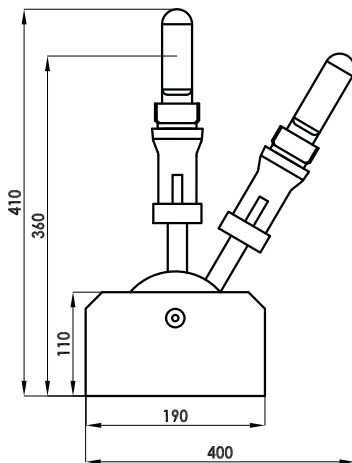

Type B

MLC 02-A Lampchanger

2-place automatic lampchanger for lighthouses and beacons.

For lamps of up to 1,000W a.c. or d.c.

Suitable for lamps and lampholders Gx9.5, G12, G22.

High mechanic and environmental resistance.

MLC 02-B Lampchanger

2-place automatic lampchanger for major lighthouses.

Special for big lighthouse lamps of up to 3,000W.

Suitable for all type of lamps and lampholders.

High mechanic and environmental resistance.

	MLC 02-A	MLC 02-B
Lamp capacity	2 nos.	2 nos.
Lamp type	- Halogen a.c., d.c. up to 1,000W. - Metal halide CDM-T up to 250W. - Xenon.	- Halogen a.c., d.c. up to 2,000W. - Metal halide and MSD up to 3,000W. - High-power Xenon.
Lampholder type	Gx9.5, G12, G22	Gx9.5, G12, G21, G22, E40
Max. lamp current	10 A	16 A
Motor system voltage	12V or 24V	12V or 24V
Lamp voltage	24V/220V	24V/220V
Max. lamp power	1,000W	3,000W
Max. lamp size	150 mm	500 mm
Lamp detecting circuit	LDR M12 photo-resistance	LDR M12 photo-resistance
Accuracy in focusing	±0.8 mm	±1 mm
Temperature range	From -30° to 85°C	From -30° to 85°C
Weight	1.4 kg	3.5 kg

MLC 160 external control unit

Control circuit:	Controlled by micro-processor.
Configuration:	User friendly.
Functions:	- LED lamp control (automatic change from main lamp to ..stand-by lamp). - Photocell control. - Remote monitoring signals.
Operating modes:	Automatic (by photocell), Manual (for maintenance) or Remote (for remote monitoring).
Voltage supply:	a.c. or d.c.
Remote monitoring:	- Status and alarms ready for remote control and monitoring, by opto-coupled signals. - RS-232 or RS-485 serial port.