



ATEX BATTERY ENCLOSURES

MCE



Mediterráneo Señales Marítimas offers a wide range of boxes with ATEX Classification to house gelled electrolyte batteries from 60 up to 1,700 Ah. These enclosures are intended for use in potentially hazardous areas with presence of flammable liquids, gases or vapours (Zone 1 and Zone 2).

These boxes may be delivered alone or as part of a kit that includes the solar panel support or battery charger, as well as the corresponding beacon; thus forming a complete ATEX beaconing kit.

The MCE enclosures are designed to withstand the harshest marine conditions.

FEATURES

✓ ATEX Classification:

GROUP II: Equipment in surface (no mining).
ZONE 1: Category 2.
ATMOSPHERE: GAS.

ZONE 2: Category 3.
ATMOSPHERE: GAS.

- ✓ Pole isolator up to 315 A.
- ✓ Made from hot-dip galvanized steel with polyurethane coating. Optional stainless steel manufacturing.
- ✓ Locking bolts in stainless steel.
- ✓ IP 54 watertightness degree (IP 66 optional).
- ✓ Adjustable battery internal fixing frame.
- ✓ Cable input through anti-vibration ATEX glands.
- ✓ Vandal-proof safety lock as option.



II 2 G Ex d IIB T6

ATEX BATTERY ENCLOSURES

MCE

Specifications subject to change without previous notice.

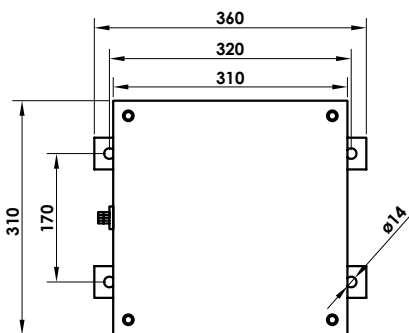
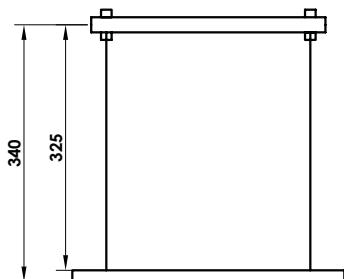

MCE 100

ATEX Enclosure Dimensions				
Model	Length	Width	Height	Weight
MCE 100	500 mm	450 mm	400 mm	65 kg
MCE 200	750 mm	500 mm	500 mm	90 kg
MCE 300	800 mm	500 mm	600 mm	128 kg
MCE 400	800 mm	500 mm	750 mm	135 kg
MCE 500	800 mm	600 mm	750 mm	150 kg

Pole isolator		
Model	Amps	Input diameter
FPI 01	40	2 x M25
FPI02	63	2 x M25
FPI 03	80	2 x M25
FPI 04	125	2 x M32
FPI 05	160	2 x M40
FPI 06	250	2 x M50
FPI 07	315	2 x M50

Standards and Methods of Protection
General requirements: EN 60079-0 Standard.
Equipment protection by Flameproof Enclosures: "d", EN 60079-1 Standard.
Temperature Class: T6. 85°C.
Protection against Gas: (G).

Technical battery data and recommended ATEX enclosure for each type

Type	Nom. voltage (V)	Nominal capacity C ₁₂₀ 1,85 V/C 20°C (Ah)	Length max. (mm)	Width max. (mm)	Height to the top max. (mm)	Height incl. connexions max. (mm)	Approx. Weight (kg)	ATEX enclosure	No. of batteries
SB12/60 A	12	60	278	175	-	190	19	MCE 100	1
SB12/75 A	12	75	330	171	214	236	26.5	MCE 100	2
SB12/100 A	12	100	513	189	195	223	36.5	MCE 200	3
SB12/130 A	12	130	513	223	195	223	45.5	MCE 200	3
SB12/185 A	12	185	518	274	216	238	62.5	MCE 200	3
SB6/200 A	6	200	246	192	254	275	29	MCE 200	4
SB6/330 A	6	330	312	182	337	359	47	MCE 200	4
A602/370 Solar	2	367	126	208	357	399	23	MCE 100	6
A602/440 Solar	2	440	147	208	357	399	27	MCE 100	6
A602/520 Solar	2	519	126	208	473	515	30	MCE 300	6
A602/625 Solar	2	623	147	208	473	515	35	MCE 300	6
A602/750 Solar	2	727	168	208	473	515	39	MCE 300	6
A602/850 Solar	2	848	147	208	648	690	49	MCE 400	6
A602/1130 Solar	2	1131	212	193	648	690	66	MCE 400	6
A602/1415 Solar	2	1413	212	235	648	690	80	MCE 400	6
A602/1695 Solar	2	1695	212	277	648	690	95	MCE 500	6



MEDITERRÁNEO SEÑALES MARÍTIMAS, S.L.L.
 mesemar@mesemar.com • www.mesemar.com

