



LED MARINE LANTERN

MBL 350



The MBL 350 is a LED flashing lantern of medium and long range, with a great optical efficiency and low consumption. Its luminous source consists of high-power LED diodes, obtaining a range of up to 20 nautical miles.

Intended to be placed in on-shore aids-to-navigation locations, such as poles and towers, with a minimum maintenance.

Fitted with 6 nos. optical elements by level, arranged in a circular way in a 250mm diameter, made from UV-resistant methacrylate and protected with a shock-resistant acrylic lens cover. Manufactured with high-quality and resistant materials, this lantern provides a long service life under severe marine conditions.

Designed according to IALA Recommendations.

FEATURES

- ✓ High-efficiency luminous system.
Up to 13 nm ($T=0.74$), 20 nm ($T=0.85$).
- ✓ Vertical divergence up to 12° .
- ✓ 360° horizontal output.
- ✓ Average operation lifetime over 10 years.
- ✓ Photocell adjustable in lux.
- ✓ IP 67 watertightness degree (immersion resistant).
- ✓ Linear adjustment of luminous intensity.
- ✓ Double RS-232 serial port for setting adjustments by PC and remote monitoring system.
- ✓ Programming, configuration and operating status via PC, IR programmer or Bluetooth.
- ✓ Ready to integrate remote monitoring via GSM, VHF or satellite, synchronization via GPS or AIS AtoN module.
- ✓ Short-circuit, reverse-polarity and transient over-voltage protections.
- ✓ **PATENTED OPTICAL SYSTEM.**



LED MARINE LANTERN

MBL 350



Specifications subject to change without previous notice.

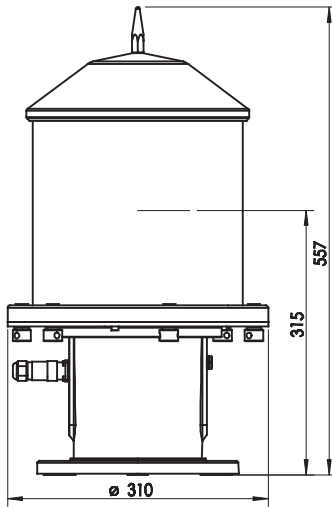

MBL 350 of 3 levels.

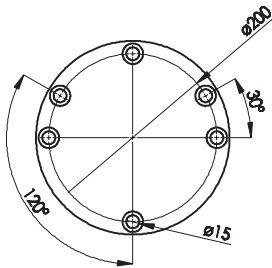

Options

- Infrared (IR) programmer.
- PC programming kit.
- RS-485 MODBUS serial port.
- Marine aluminium base.
- Other specifications available under request.
- MBL 350-HD (up to 30° divergence).
- MBL 350-SYNC (GPS synchronisation).
- MBL 350-TG (GSM remote monitoring).
- MBL 350-TR (Radio remote monitoring).
- MBL 350-TS (Satellite remote monitoring).
- MBL 350-AIS (AIS AtoN).

Optical System

Light source:	18 to 36 nos. ultra-bright LED diodes, with high-precision acrylic lens.
Luminous range:	Up to 13 nm (T=0.74) 20 nm (T=0.85).
Colours available:	White, green, red, amber and blue.
Vertical divergence:	From 5° to 12° (50% lo).
LED average life:	More than 100,000 hours.
Power supply:	From 9 to 36V.
Lantern consumption:	From 36 to 72W.

Electronic control

Flash rhythms:	256 (6 nos. user selectable).
Day/night threshold:	Adjustable between 10 and 400 lux.
Settings:	PC / IR programmer / Bluetooth.
Luminous intensity adjustment:	Linear, between 10 and 100%.
Light intensity reduction due to low battery:	Configurable by the user.

Materials and environment

Base:	Glass-fibre reinforced polyamide PA66-GF30.
Lens cover:	Acrylic, UV stabilised.
Shock resistance:	MIL-STD-202G, Method 213B.
Watertightness degree:	IP 67.
Fixings:	3 - 4 bolts in a 200mm diameter.
Humidity resistance:	100%. Pressure-compensation valve to avoid condensation.
Temperature range:	From -30° to 70°C.
Inside hardware:	Stainless steel.

MBL 350	PEAK INTENSITIES (Cd)			
	VERTICAL DIVERGENCE 5°		VERTICAL DIVERGENCE 12°	
COLOUR	3 levels	6 levels	3 levels	6 levels
White	3,510	7,020	1,635	3,270
Green	2,235	4,470	1,302	2,604
Red	1,500	3,000	807	1,614
Amber	1,986	3,972	1,104	2,208

Other divergences available.



MEDITERRÁNEO SEÑALES MARÍTIMAS, S.L.L.
 mesemar@mesemar.com • www.mesemar.com

