



Our range of wreck-marking buoys is especially indicated for both sheltered and open-sea waters, since they are available in diameters from 0.8 to 1.8 m.

Thanks to their high resistance and low weight, they are ideal for a quick installation, thus guaranteeing the correct beaconing of the wreck area. Manufactured with high-quality and resistant materials, these buoys provide a long service life under the harshest marine conditions.

Their float, of high elasticity and lightweight, is manufactured with closed-cell polyethylene solid foam sheet (no water absorption) and projected with a layer of coloured polyurethane elastomer (chromaticity according to IALA Recommendations).

FEATURES

- ✓ Designed as emergency buoys for the marking of Wrecks and New Hazards in accordance with IALA Recommendation No. O-133 of December 2005.
- ✓ Float manufactured with closed-cell polyethylene foam sheet (no water absorption) projected with a layer of coloured polyurethane elastomer.
- ✓ High shock resistance.
- ✓ Galvanized-steel superstructure
- ✓ Stainless-steel hardware.
- ✓ UV- and corrosion-resistant polyurethane paint.
- ✓ Ideal complement to our MCL 250-N wreck-marking compact LED lantern.
- ✓ Day marks as an option, to increase buoy conspicuity at daytime.
- ✓ Passive radar reflector of 10 m² RCS.
- ✓ Minimum maintenance.



WRECK-MARKING BUOYS

EBM-N



Specifications subject to change without previous notice.

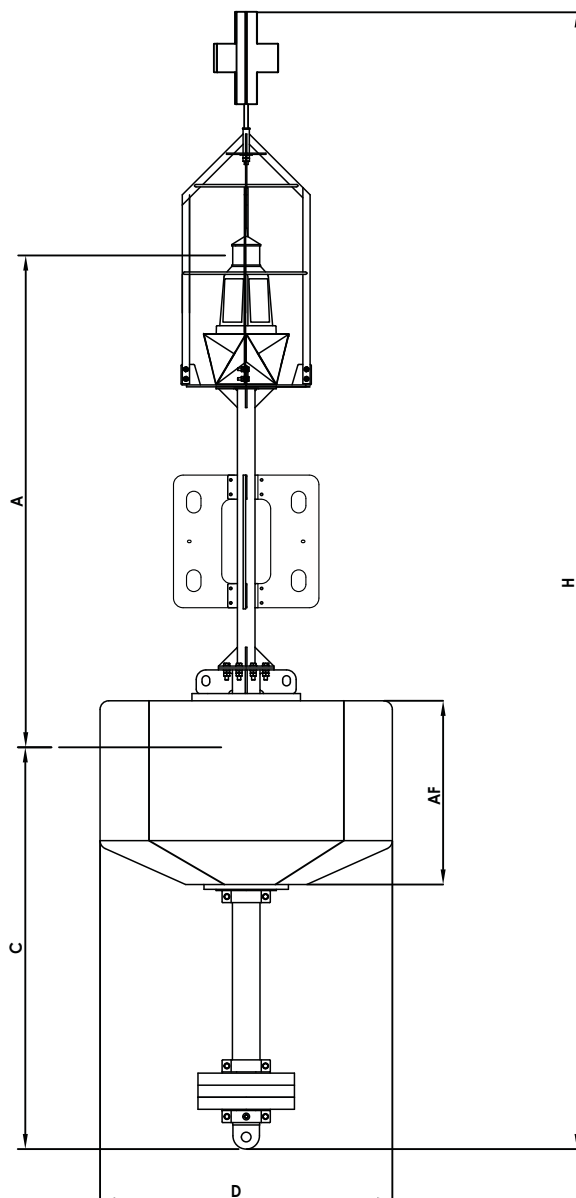

Superstructure	
Material:	Hot-dip galvanized steel.
Coating:	UV- and corrosion-resistant polyurethane paint.
Day marks:	Stainless steel.
Top mark:	According to IALA Recommendations.
Radar reflector:	10 m ² (X Band).
Solar modules capacity:	Up to 4 nos. solar modules of 75W (maximum).
Batteries capacity:	Up to 130 Ah, in watertight cabinet with safety lock.
Lifting eyes:	2 nos.
Hardware:	Stainless steel.

Float	
Diameter:	From 0.8 to 1.8 metres.
Material:	Closed-cell polyethylene foam sheet.
Coating:	Projected with a layer of coloured polyurethane elastomer, UV resistant.
Top surface:	Anti-sliding.

Tail	
Material:	Hot-dip galvanized steel.
Ballast weights:	Treated steel, detachable.
Mooring eye:	1 no.
Protection:	Sacrifice anodes.

Options	
Superstructure made from stainless-steel or marine aluminium.	
High-visibility day marks.	
Passive radar reflector available up to 36 m ² RCS.	
Active radar reflector.	
Cast-iron ballast weights.	
Skirt or short tail available.	
Other float volumes available under request.	

MODEL	(D) FLOAT DIAMETER (*)	(A) FOCAL HEIGHT (*)	(AF) FLOAT HEIGHT (*)	(C) DRAFT	(H) TOTAL HEIGHT (*)	FLOAT VOLUME (**)	TOTAL WEIGHT	MAX. CHAIN
EBM-N 08	0.8 m	1.7 m	2,000 mm	2,290 mm	4,930 mm	1.00 m ³	370 kg	300 kg
EBM-N 12	1.2 m	2.0 m	730 mm	1,350 mm	4,300 mm	0.75 m ³	330 kg	350 kg
EBM-N 15	1.5 m	2.5 m	950 mm	2,200 mm	6,100 mm	1.20 m ³	400 kg	500 kg
EBM-N 18	1.8 m	3.0 m	1,100 mm	2,760 mm	7,400 mm	2.50 m ³	900 kg	1,300 kg

*Other diameters and heights available under request.

**Other volumes available under request.



MEDITERRÁNEO SEÑALES MARÍTIMAS, S.L.L.
 mesemar@mesemar.com • www.mesemar.com

